

KRAIBURG WINGFLEX

Prerequisites:



Concrete area:

- No holes
- No ridges
- Min. 3% slope

Mats:

Even temperature:
min. 5°C to max. 30°C
(store according to initial temperature)

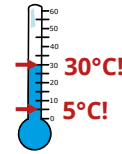

For animal well-being, a certain amount of bedding is necessary to absorb moisture (e.g. soft milled straw or mineral material)!

You will need:

Measuring:

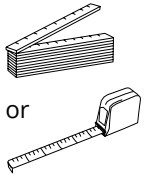

Marking:

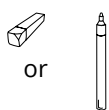

Cutting:

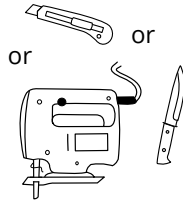

Drilling and installing:

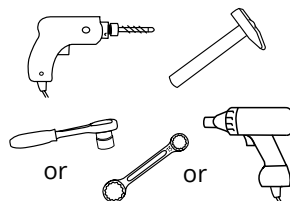

KRAIBURG fixings:

- Framing plugs \varnothing 10 x 100 mm with
- Hexagon screws (AF 13) - A2
- Washers \varnothing 30 mm - A2

(Fixings are part of the delivery)



Mat width:

102 cm

102 cm

112 cm

112 cm

112 cm

Connecting bar width:

8 cm

13 cm

8 cm

13 cm

18 cm

Free stall width:

110 cm

115 cm

120 cm

125 cm

130 cm



Do not stack the pallets!

1 Install row of mats completely and set distances using an installation tool

i Start from the center of the row of stalls and install on the right and on the left

Fixing points at the front edge

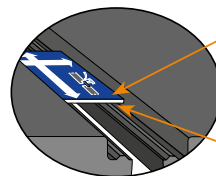
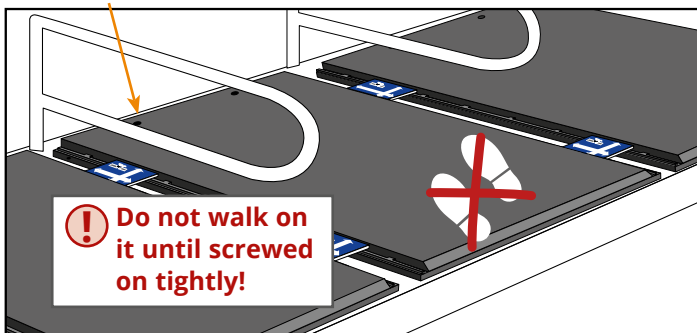

To install loosely, set distance between the mats using the installation tools (wider than connecting bar)

Indent installation tools approx. 20 cm

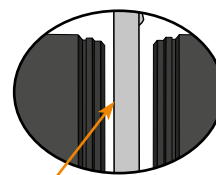

Position underneath the divider (+/- 6 cm)

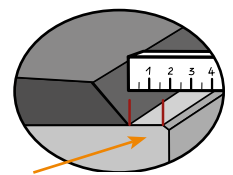

Rear concrete edge: 0 - 3 cm distance

! When pulling the mat, take care that the wings do not fold to the opposite direction!

2 Insert connecting bars

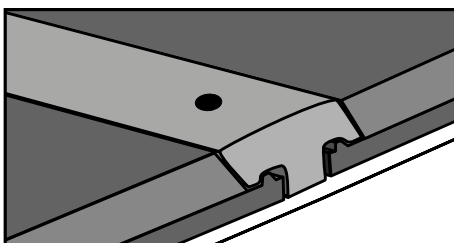

- Chamfered side on the rear edge
- Connecting bar engages flush with the interlocking rear edge of the mat



3 Fix connecting bars 5 times, but do not yet tighten fully

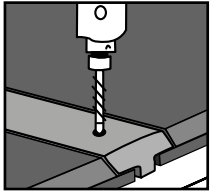

Drill

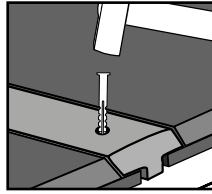

Knock the plastic plugs in flush

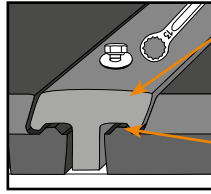

Loosely tighten the screws and washers, do not yet tighten fully

Connecting bar engages in the flute of the edge of the mat

Flute



Tip:
Avoid slippage:

- Fix at one fixing point
- Then drill further holes, etc.

When the whole row of lying mats is installed and fixed loosely:

4 Fix connecting bars and mats

A Fix connecting bars 5 times

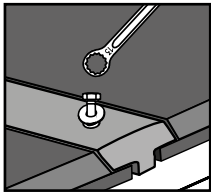

Finally, tighten all the pre-assembled screws

B Fix mats at the front edge twice

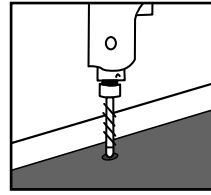

Drill

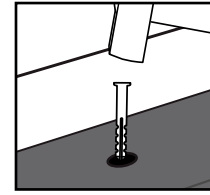

Knock the plastic plugs in flush

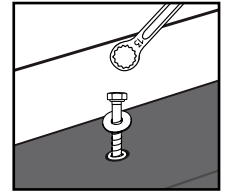

Tighten screws and washers

! Tighten screws until they are seated evenly and firmly and are slightly countersunk. **Do not overtighten!**

5 Fix last side edge of the mat

With "end" bar:

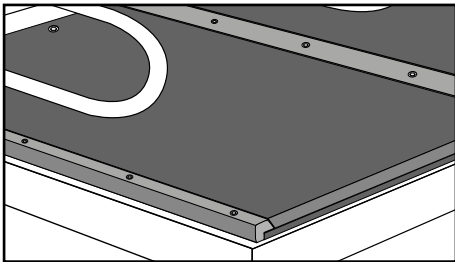

Fix with "end" bar

or

Without bar:

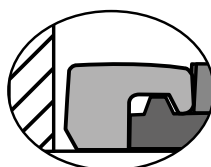

Min. 0.5 cm distance to the wall

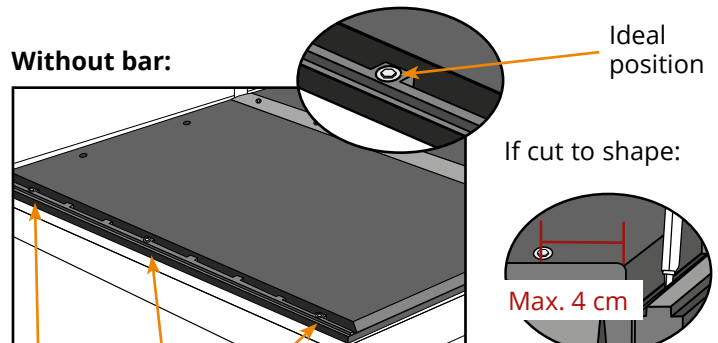

Fix the edge with 3 fixings

Ideal position

If cut to shape:

Max. 4 cm

Place the fixing max. 4 cm away from the upper edge of the mat

Mushroom dividers

Mat:

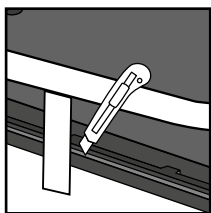

Thinner side edge can be cut in up to 3 cm

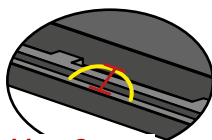

Max. 3 cm

Connecting bar:

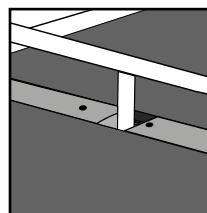

If required, divide the connecting bar, adapt and **additionally fix it**



A handsaw or a handheld circular saw is suitable for adapting the connecting bars.



IMPORTANT: Connecting bar covers the joint over the whole length of the mat (also with mushroom dividers)